

Pressure Sensor

(AWPSS-Nxxx)

PRODUCT SPECIFICATION SHEET



FEATURES

- Linearity out put(V)
- No-contact
- Excellent durability
- Reasonable price, etc...

CONTENTS

Application	1
Features	1
Specifications	1~2
Dimensions	3

APPLICATION

This switch is used in water pressure-sensing of heating pipe in the wall hung gas boiler.

This switch has application to sensing of water pressure in heating apparatus.

SPECIFICATIONS

Type	: Pressure type	
Installation	: Vertical and horizontal	
Permissible fluid	: Air, Water	
Allowable fluid temperature	: 0 ~ 80 °C (It shall not be frozen)	
Allowable ambient temperature	: 0 ~ 60 °C	
Pressure range	: 0 ~ 1bar, 0 ~ 4bar (It can be changed by customer)	
Rupture pressure	: 10bar	
Power supply	: DC 5V	
Output	: DC 0.5V ~ 4.5V (It can be changed by customer)	
Material	Body	PA66 (G/F 30%)
	Diaphragm	EPDM
	O-ring	S-11.2
	Spring	SUS304

SPECIFICATIONS

Current consumption	: Less than 15mA
Connection	: PF1/4" male (Can be added by customer)
Electrical connection	: Rast 2.5, 3-pole or 4-pole
Accuracy	: ± 3.0 (% F.S)
Life cycle	: 100,000 Cycle (On 10 seconds, Off 10 seconds)
Weight	: 23.5g

OUTPUT

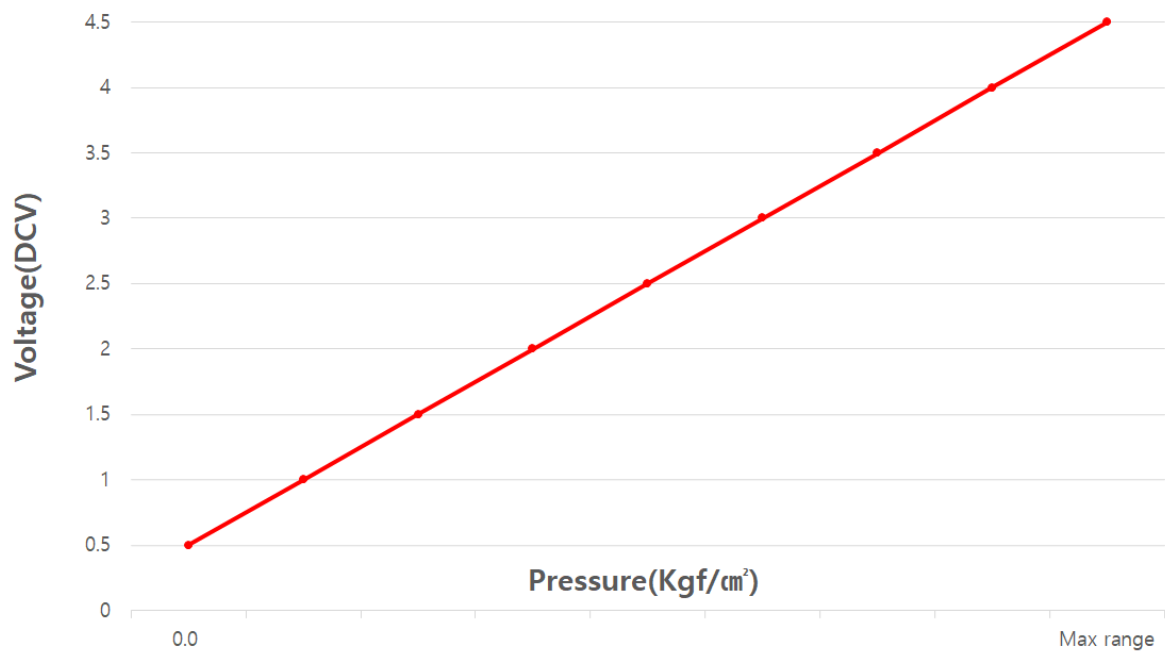

ELECTRICAL CONNECTIONS

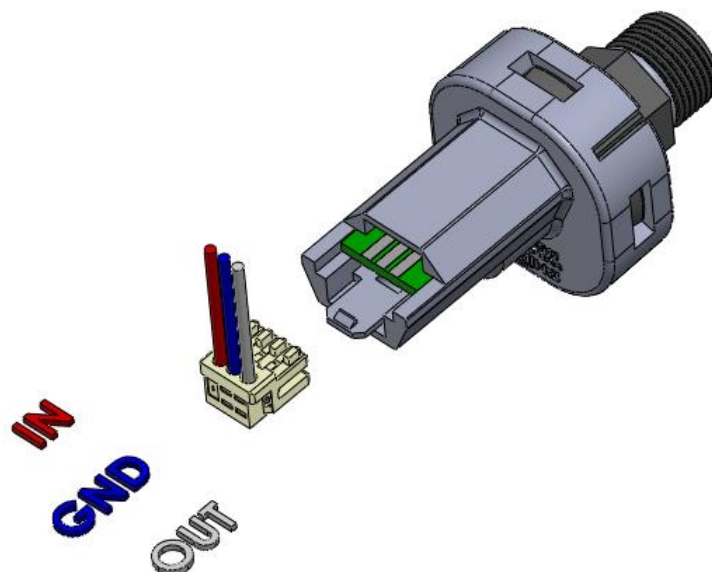

DIMENSION

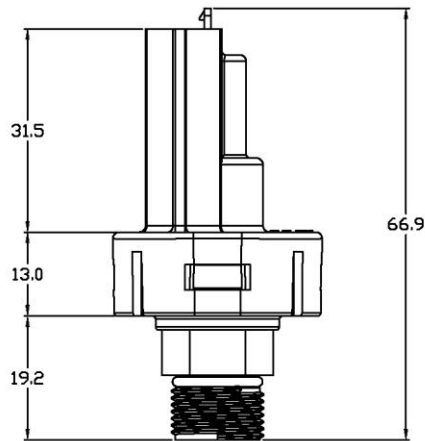
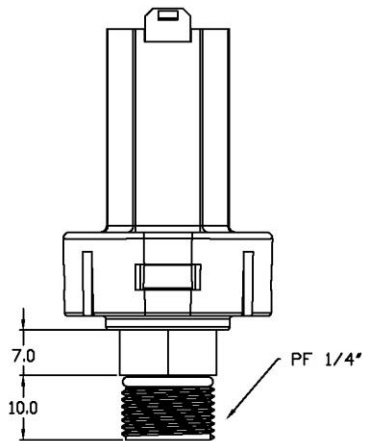
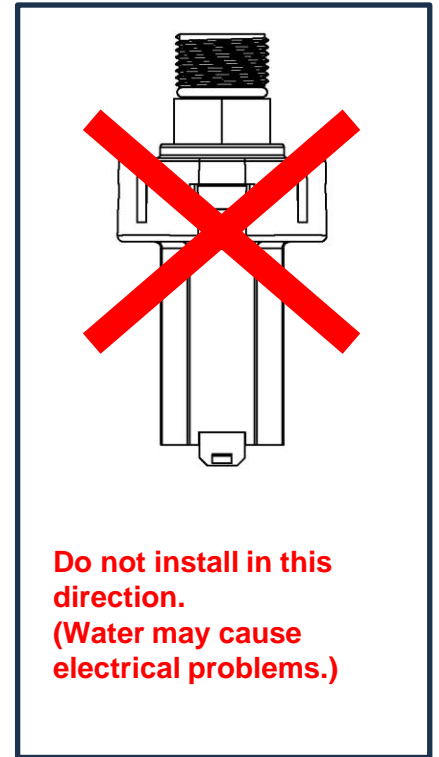
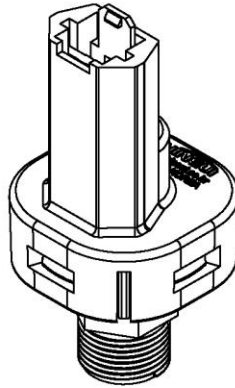
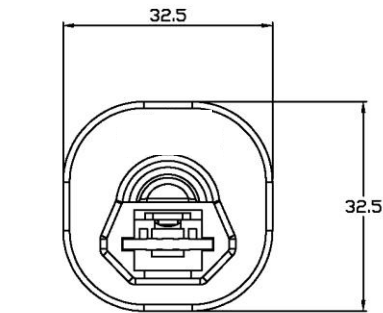

• PF 1/4" male

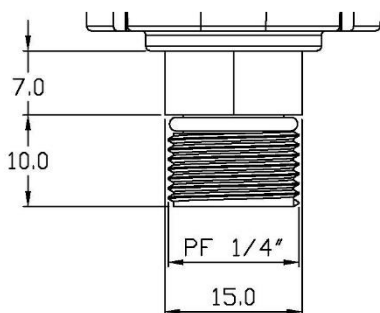

• Fast connection(Clip)

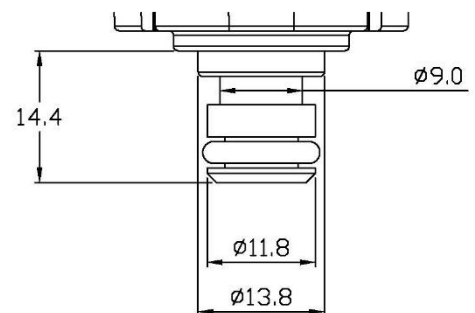

- The specifications and dimensions can be changed without warning.
- Warranty 1 year.