

Water Pressure Switch (High-Low signal)

(AWPSS-04P HL)

PRODUCT SPECIFICATION SHEET



FEATURES

- High - Low output(V)
- No-contact
- Excellent durability
- Reasonable price, etc..

CONTENTS

Features	1
Application	1
Specifications	1~2
Dimensions	3

APPLICATION

This sensor is usually used in water purifier , coffee machine , etc.

SPECIFICATION

Medium	air or water
Operating pressure	On point : 1 bar ~ 10 bar (On point : Nomal Low or Nomal HSigh)
	Within X% of On point (X% : Customer requests)
Rupture pressure	20 bar
Materials in contact with medium	- Cover : POM (※Optional : FDA certified materials.) - Body : PA66(GF 30%) - Sensor : Hall IC
Rubber	- EPDM : Air, Water
Temperature	- Medium and ambient : 0 °C ~ 85 °C (It shall not be frozen)
	- Storage : -30 °C ~ 80 °C
	-Rupture : 95 °C
Power supply	- DC 5V
Output	- DC 0.5 ~ 4.5V (standard) / DC 0 ~ 5V (It can be changed by customer' request)
Current consumption	less than 15mA

PRESSURE SENSOR

Pressure connection	1/4" fitting (Refer to Dimension)
Electrical connection	YEONHO, SMH250-03
Installation Direction	Free
Protection standard	IP 00
Tolerance at setting point	Provided separately according to on-point
Life Cycle	high pressure/ minimum pressure: 5 sec – 100,000 Cycle
weight	35g

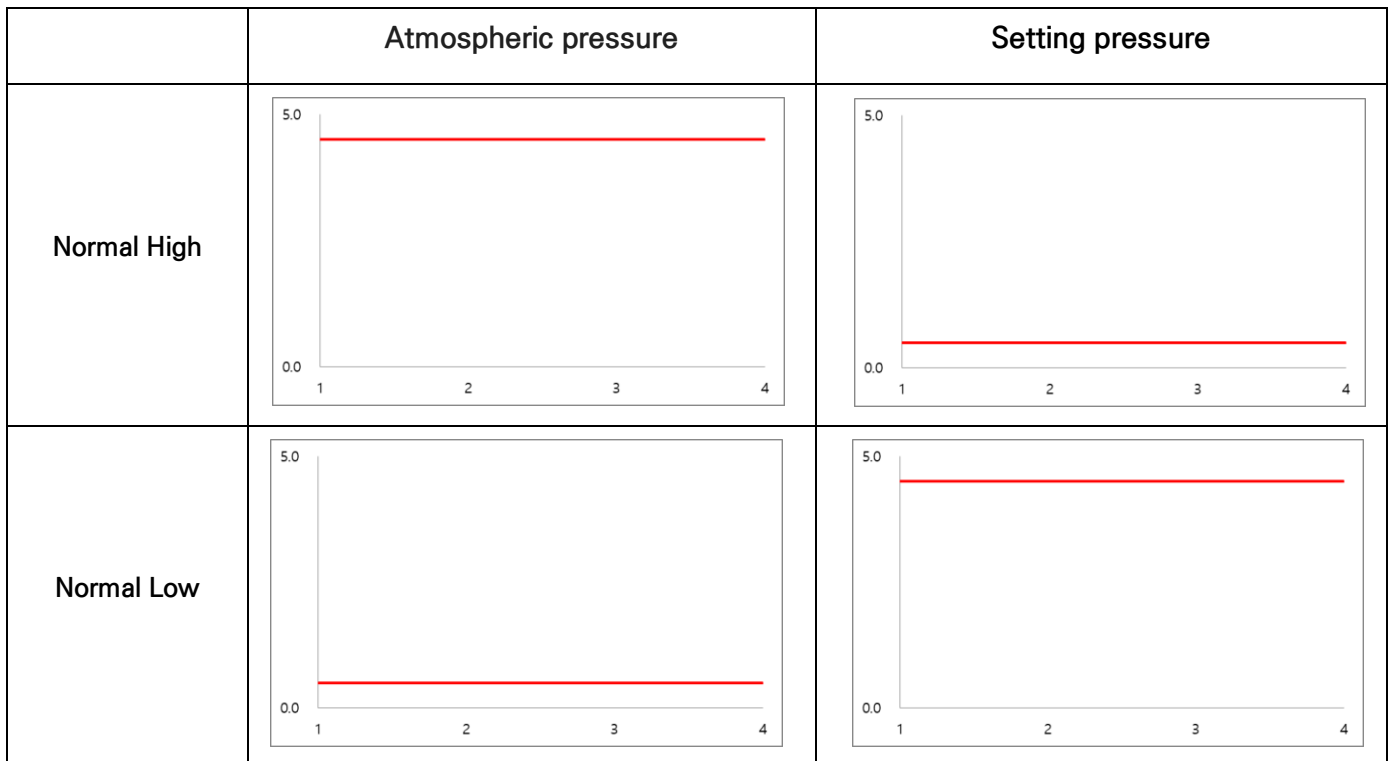

OUTPUT

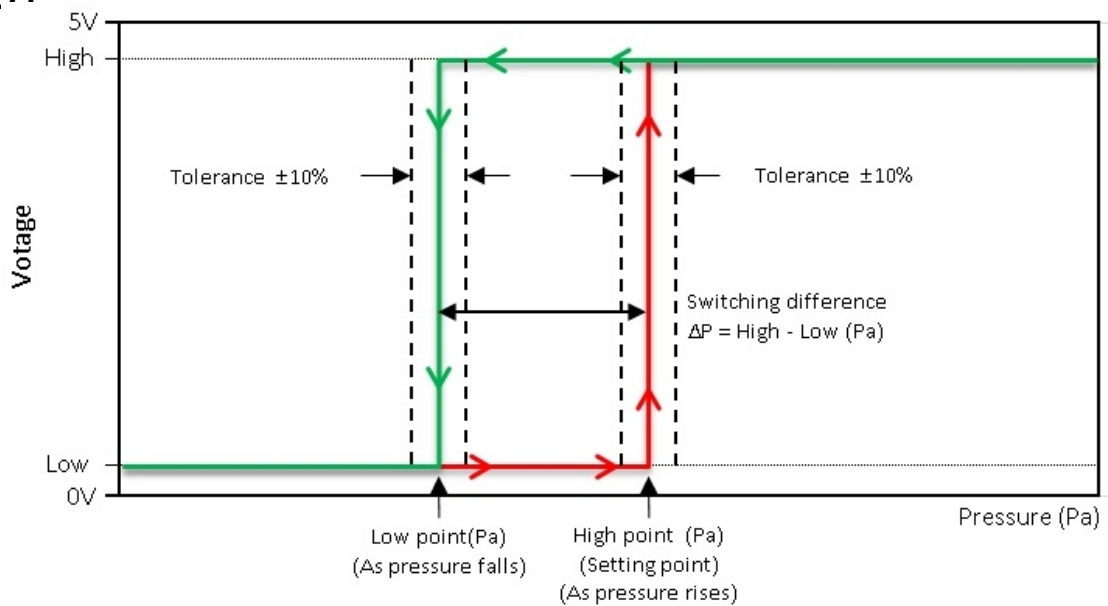

DIMENSION

Pin 3 2 1

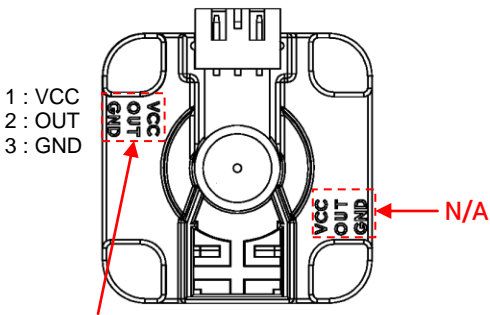

AWPSS 04P HL
(High - Low type)

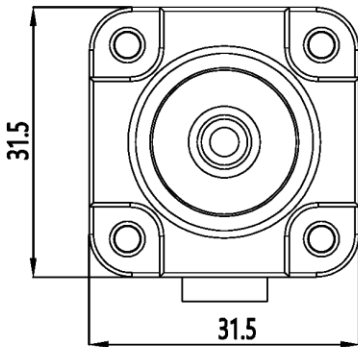
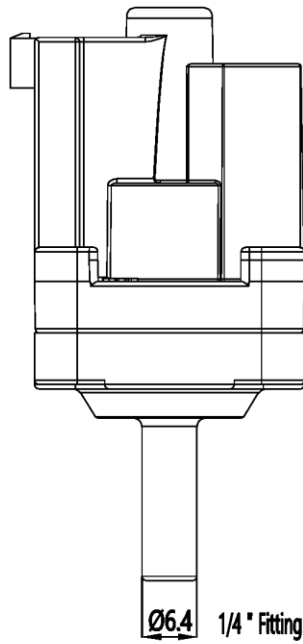
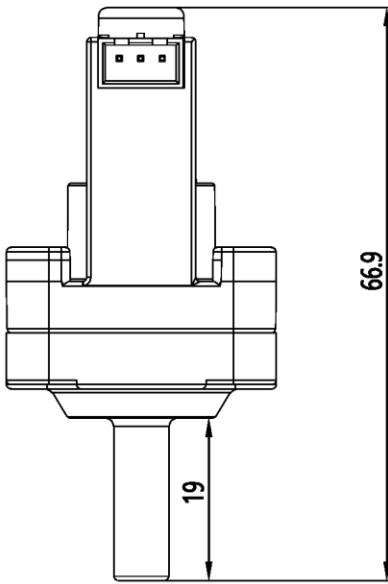
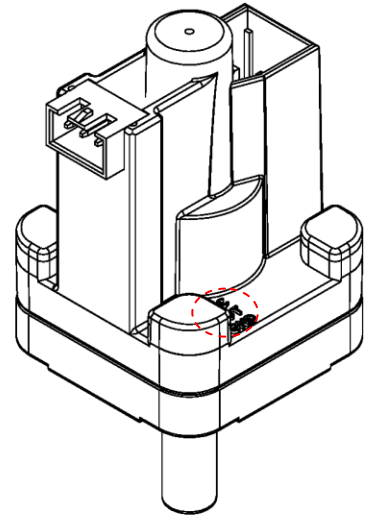

Mates With Part
(HOUSING : SMH-250-03 , YEONHO
TERMINAL : YST025 YEONHO)

Pin NO.3 VCC
Pin NO.2 OUT
Pin NO.1 GND

The specifications and dimensions can be changed without warning.